

## Cooling Channel Product

The working principle of the closed cooling channel is to isolate the cold air supply from the hot exhaust air and to concentrate the cooling on the air intake of the equipment. This process is known as concentrated cooling. It is achieved by installing server cabinets with their air intakes facing the cooling channel. This type of cooling channel prevents the mixing of hot and cold air, which means that less energy is required to maintain the system at a controlled and consistent temperature. The cooling channel is divided into double-row and single-row configurations. The cooling channel consists of flip skylights, fixed glass skylights, automatic sliding doors, M-type slot, cabinet rear panel, and so on.

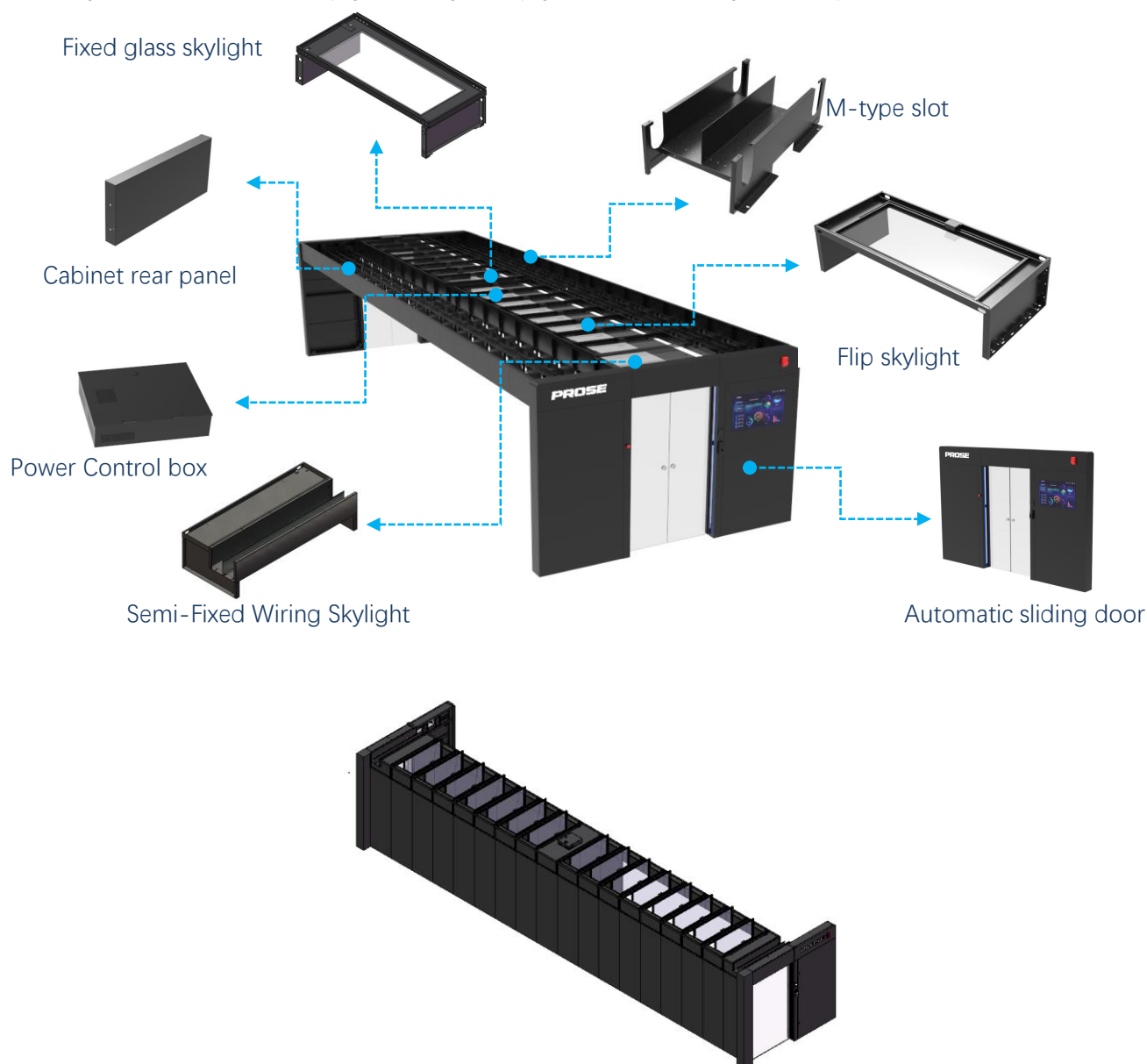

Comply with EIA-310-E, IEC297-2 and DIN41491; PART1, DIN41494; PART7, GB/T3047.2-92 standard; Compatible with ETSI standard.

### 1) Automatic Sliding Door

Description: The automatic sliding door frame is made of cold-rolled steel plate, with a modular design, solid structure, and is reliable and safe. The door can be manually opened by a button or remote control and can close automatically. The door frame has a reserved installation position for the access control system. The inside of the door frame is equipped with a human body sensor, and the door has an anti-pinch function when it is closing and opening. The bottom of the door is in contact with the ground, and the door edge is attached with soft buffer material to prevent air leakage when the door is closed.

The door opens by sliding the glass embedded in the steel frame; the glass thickness is not less than 10mm, with a light transmittance of 90%; the sealing performance between the door and the frame can effectively inhibit airflow. Both hot and cold aisles are equipped with high-quality sliding doors, sliding door hanging rails, and heavy-duty nylon silent pulleys, ensuring that the cold aisle can be easily opened and closed by sliding. Usage: Used for the security door entrance and exit at both ends of the cold aisle.

Color: Black RAL9005



Item	Automatic Sliding Door
Size (mm)	3600(W) x 200(D) x 2300(H)
Corridor Width(mm)	1200
Weight	About 220kg
Color	Black, RAL9005
Frame Material Thickness	SPCC, ≥2.0mm
Meet Standard	ANSI/EIA RS-310-D, IEC297-2, DIN41491, DIN41494, GB/T3047.2-92
Door Material	Transparent Tempered Glass, 10mm thick; light transmittance of the glass is 90%.
Door Opening Method	Double doors, sliding open to both sides.
Door Opening Function	Ability to keep door open when service is required in cold air enclosure; Door opens manually by button or remote, with the ability to close automatically
Safety Feature	Anti-pinch when opening and closing the door
Fingerprint lock installation area	Reserve installation positions for multifunctional access control systems on the frame.
Salability	The door base contacts the floor, the door edge is fitted with soft cushioning material to prevent air leakage when the door is closed.
Alarm	Audible and Visual Alarm; Alarm Light; When a fire alarm is triggered, the alarm will sound and the lights will flash, and the alarm light will turn red; At the same time, the sliding door will open for 20s to facilitate the evacuation of personnel inside.

### 2) Semi-Fixed Wiring Skylight

Description: Made of cold-rolled steel plate, fixed through modular installation, with a sturdy, reliable, and safe structure.

Usage: The 300mm wide fixed skylight is used for installing surveillance cameras, temperature and humidity sensors, smoke detectors, and other equipment; the 300mm wide wiring channel is for the overhead crossing wiring of strong and weak electrical lines in the passage. Surface treatment: degreasing, pickling, phosphoric acid, powder coating.

Color: Black RAL9005



Item	Semi-Fixed Wiring Skylight
Size (mm)	600(W) x 1400(D) x 350(H)
Corridor Width(mm)	1200
Weight	About 40kg
Color	Black, RAL9005
Material Thickness	SPCC, ≥1.5mm
Meet Standard	ANSI/EIA RS-310-D, IEC297-2, DIN41491, DIN41494, GB/T3047.2-92
Function	The 300mm wide fixed skylight is used for installing surveillance cameras, temperature and humidity sensors, smoke detectors, and other equipment; the 300mm wide wiring channel is for the overhead crossing wiring of strong and weak electrical lines in the passage.
Lighting Fixture	Lighting fixtures installed on the inside of the skylight, with a brightness greater than 300lux, and the lights can be turned on via motion sensor.

### 3) Flip Skylight

Usage Instructions: Made of cold-rolled steel plate + white PC board, with a modular design for easy installation and disassembly, featuring a sturdy and reliable structure. Flip skylight is embedded with a white PC board, with a PC thickness of  $\geq 4\text{mm}$ . The light transmittance of the PC is 85%. The flip skylight must be equipped with an electromagnetic lock, which automatically flips down when there is a power outage, fire alarm, or upon receiving a fire signal, thereby effectively extinguishing the fire; the opening angle of the top plate after flipping is  $\geq 88$  degrees. The skylight and its installation accessories match the width of the cabinet. Flip skylight will not collide with other equipment when rotating. Purpose: Used for cold aisle skylights, linked with fire signal control. Surface Treatment: Degreasing, pickling, phosphating, powder coating.

Color: Black RAL9005.



Item	Flip Skylight
Size (mm)	600(W) x 1400(D) x 350(H)
Corridor Width(mm)	1200
Sunroof Deflection Angle	$\geq 88^\circ$
Area Ratio of Skylight to Roof	$\geq 70\%$
Weight	About 60kg
Sheet Metal Color	Black, RAL9005
Material Thickness	SPCC+PC; SPCC, $\geq 1.5\text{mm}$ ; The white PC board is 4mm thick; light transmittance of the PC is 85%.
Meet Standard	ANSI/EIA RS-310-D, IEC297-2, DIN41491, DIN41494, GB/T3047.2-92
Rotation Mode	The ceiling panel system operates on the principle of self-tilting. Each ceiling panel has an impact point to actively operate the individual ceiling panel.
Ceiling panels are designed to	Consistent with the width of the cabinet.; Allow easy installation and removal.
Lighting Fixture	Lighting fixtures installed on the inside of the skylight, with a brightness greater than 300lux, and the lights can be turned on via motion sensor.

#### 4) Fixed Glass Skylight

Instruction: The cold-rolled steel plate is adopted, the thickness of the material is greater than or equal to 1.2mm, and it is fixed by modular installation, with firm, reliable and safe structure.

The skylight frame is embedded with glass, and the thickness of the glass is not less than 4mm, which meets the standard of GB15763.2 -2005 Safety Glass for Buildings.

Usage: used for sealing the top of cold passage.

Surface finish: degreasing, pickling, phosphoric acid, powder coating.

Color: black RAL9005/ gray RAL7035



Item	Fixed Glass Skylight
Size (mm)	600(W) x 1400(D) x 350(H)
Corridor Width(mm)	1200
Weight	About 35kg
Color	Black, RAL9005
Material Thickness	SPCC, ≥1.5mm; Glass, 5mm
Meet Standard	ANSI/EIA RS-310-D, IEC297-2, DIN41491, DIN41494, GB/T3047.2-92
Function	Designed for installing surveillance cameras, temperature and humidity sensors, smoke detectors, and other equipment in cold aisles.
Lighting Fixture	Lighting fixtures installed on the inside of the skylight, with a brightness greater than 300lux, and the lights can be turned on via motion sensor.

### 5) Fixed Steel Skylight

Description: Made of SPCC, with a thickness of  $\geq 1.5\text{mm}$ , consistent with the width of the cabinet, modular installation for a sturdy, reliable, and safe structure.

Usage: Designed for installing surveillance cameras, temperature and humidity sensors, smoke detectors, and other equipment in cold aisles.

Surface Treatment: Degreasing, pickling, phosphating, and powder coating.

Color: Black RAL9005



Item	Fixed Steel Skylight
Size (mm)	600(W) x 1400(D) x 350(H)
Corridor Width(mm)	1200
Weight	About 30kg
Color	Black, RAL9005
Material Thickness	SPCC, $\geq 1.5\text{mm}$
Meet Standard	ANSI/EIA RS-310-D, IEC297-2, DIN41491, DIN41494, GB/T3047.2-92
Function	Designed for installing surveillance cameras, temperature and humidity sensors, smoke detectors, and other equipment in cold aisles.
Lighting Fixture	Lighting fixtures installed on the inside of the skylight, with a brightness greater than 300lux, and the lights can be turned on via motion sensor.

### 6) Cabinet Rear Panel

Description: Made with SPCC, thickness  $\geq 1.2\text{mm}$ , matching the width of the cabinet, modular installation for fixation, ensuring a sturdy, reliable, and safe structure.

Usage: Designed for shielding the top and rear of the cabinet.

Surface Treatment: Degreasing, pickling, phosphating, and powder coating.

Color: Black RAL9005.



Item	Cabinet Rear Baffle
Size (mm)	600(W) x 50(D) x 350(H)
Weight	About 5kg
Color	Black, RAL9005
Material Thickness	SPCC, $\geq 1.2\text{mm}$
Meet Standard	ANSI/EIA RS-310-D, IEC297-2, DIN41491, DIN41494, GB/T3047.2-92
Function	Designed for shielding the top and rear of the cabinet.

### 7) Power Control Box

Usage instructions: It is used to control the power supply of skylight, access door and lighting, connect fire signal, and open the skylight and access door through the fire alarm information.

Color: black RAL9005



Item	Power Control Box
Size (mm)	400(W) x 300(D) x 100(H)
Weight	About 13kg
Color	Black, RAL9005
Material Thickness	SPCC, $\geq 1.2\text{mm}$
Meet Standard	ANSI/EIA RS-310-D, IEC297-2, DIN41491, DIN41494, GB/T3047.2-92
Function	Open the skylight and access the door through the fire alarm information.

8) Frame

Usage instructions: Adopting a metal structure, used for supporting positions in inorganic cabinets.

Color: black RAL9005



Item	Frame
Size (mm)	600(W) x 50(D) x 2000(H)
Weight	About 23kg
Color	Black, RAL9005
Material Thickness	SPCC, ≥1.2mm
Meet Standard	ANSI/EIA RS-310-D, IEC297-2, DIN41491, DIN41494, GB/T3047.2-92
Function	In the passage where cabinets cannot be placed, frames are used instead to support the cold aisle skylight and for sealing purposes.



CC- XXXXX x XXXX x XXXX - X X X X X X X X

1 2 3 4 5 6 7 8 9 10 11

Product type	1.length	2.width	3.height
CC: Cooling channel	12000:12000mm	1200:1200mm	2600:2600mm
4.Channel type	5.Flip skylight	6.Fixed steel skylight	7.Type of aisle door
1: single row	0: None	0: None	0: None
2: double row	1: single flip	1: 1pc	1: Automatic sliding doors with door frames
	2: double flip	2: 2pcs	2: Automatic sliding doors without door frames
			3: Manual sliding doors without door frames
			4: Manual pivot doors without door frames
8.Power control box	9.M-type slot	10.Cabinet rear panel	11.Frame quantity
0: None	0: None	0: None	0: None
1: 1pc	1: Yes	1: Yes	1: 1pc
			2: 2pcs
			3: 3pcs
			4: 4pcs

## GLOBAL FOOTPRINT

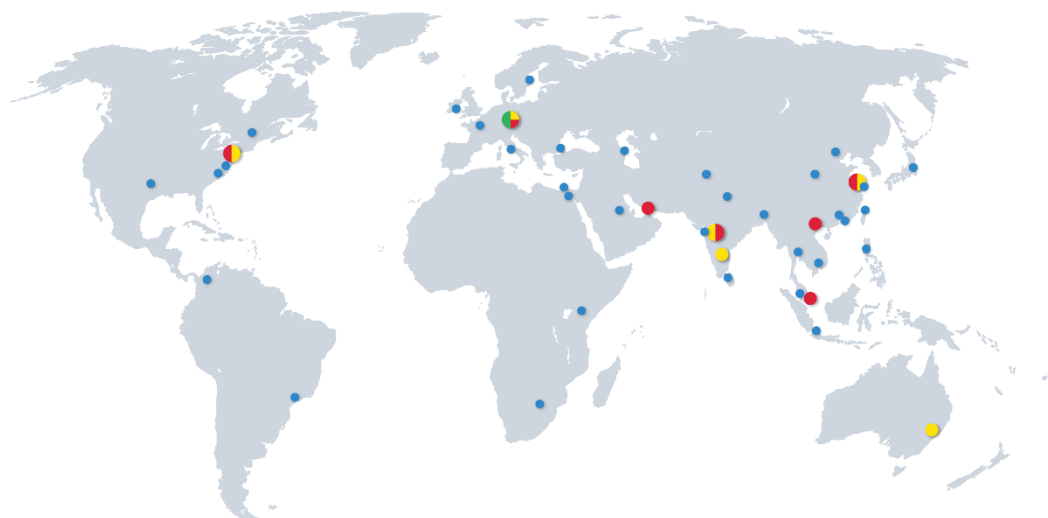

### Headquarters

**Donauwörth - Germany**  
**PROSE Technologies GmbH**  
Add.: Dr.-Friedrich-Drechsler-Straße 14, 86609  
Donauwörth, Germany  
E-mail: [info.eu@prosetechnologies.com](mailto:info.eu@prosetechnologies.com)

### Western Europe

**Dublin - Ireland**  
**PROSE Technologies (Ireland) Limited**  
Add.: 6th Floor, South Bank House, Barrow Street,  
Dublin 4 Ireland  
E-mail: [Info@prosetechnologies.com](mailto:Info@prosetechnologies.com)

### Eastern Europe & Central Asia

E-mail: [info.eeca@prosetechnologies.com](mailto:info.eeca@prosetechnologies.com)

### North America

**New Jersey - America**  
**PROSE Technologies LLC**  
Add.: 550 Clark Drive Budd Lake, NJ 07828, United  
States of America  
Tel: +1 888 840 4066  
E-mail: [info.us@prosetechnologies.com](mailto:info.us@prosetechnologies.com)

### Middle East

**Dubai - UAE**  
**PROSE Technologies DMCC**  
Add.: 3702, Mazaya Business Avenue BB2, JLT, Dubai  
Tel: +971 4 3999168  
E-mail: [info.ae@prosetechnologies.com](mailto:info.ae@prosetechnologies.com)

### Africa

**Nairobi - Kenya**  
**PROSE Technologies Africa (PTY) Ltd**  
Tel: +254 780440410  
E-mail: [info.ke@prosetechnologies.com](mailto:info.ke@prosetechnologies.com)

**Gauteng, (Johannesburg) - South Africa**  
**PROSE Technologies Africa (PTY) Ltd**  
Add.: Building 20, Cambridge Office Park, 5 Bauhina  
Road, Highveld Techno Park Centurion, Gauteng 0169,  
South Africa  
Mobile: +27 725554840  
E-mail: [info.za@prosetechnologies.com](mailto:info.za@prosetechnologies.com)

### South Asia

**Mumbai - India**  
**PROSE Technologies India Private Limited**  
Add.: 403-407, Eco Star, Vishveshwar Nagar,  
Goregaon East, Mumbai, India 400063  
Tel: +91 22-66453000  
E-mail: [info.in@prosetechnologies.com](mailto:info.in@prosetechnologies.com)

**Pune - India**  
**PROSE Technologies India Pvt.Ltd**  
Add.: A-79, Block-A, Horizon Industrial Parks, Phase II,  
MIDC Chakan Industrial Area, Khed, Pune, India  
410501  
Tel: +91 2135-635200  
E-mail: [info.in@prosetechnologies.com](mailto:info.in@prosetechnologies.com)

**Bangalore - India**  
**PROSE Technologies India Private Limited**  
Add.: No.494 East End Main Road, Jayanagar IX Block,  
Bangalore, India 560069  
E-mail: [info.in@prosetechnologies.com](mailto:info.in@prosetechnologies.com)

**New Delhi - India**  
**PROSE Technologies India Pvt.Ltd**  
Add.: H-3/157, 2nd Floor, Vikas Puri, New Delhi, India  
110018  
E-mail: [info.in@prosetechnologies.com](mailto:info.in@prosetechnologies.com)

**Dhaka - Bangladesh**  
**PROSE Technologies (Bangladesh) Limited**  
Add.: House-360 (2nd Floor), Lane-5 (East), Baridhara  
DOHS, Dhaka-1206, Bangladesh  
Tel: +880 1977070130  
E-mail: [info.bd@prosetechnologies.com](mailto:info.bd@prosetechnologies.com)

**Islamabad - Pakistan**  
Add.: Unit 514, 5th Floor, ISE Towers, Islamabad,  
Pakistan  
Tel: +92 3335357733  
E-mail: [info.pk@prosetechnologies.com](mailto:info.pk@prosetechnologies.com)

**Sri Lanka**  
Tel: +880 1977070130  
E-mail: [info.lk@prosetechnologies.com](mailto:info.lk@prosetechnologies.com)

### South East Asia

**Selangor - Malaysia**  
**PROSE Technology (M) Sdn. Bhd**  
Add.: Unit 2-1, Level 2, The Podium, Tower 3, UOA  
Business Park, No 1, Jalan Pengaturcara U1/51a,  
Seksyen U1, 40150 Shah Alam, Selangor, Malaysia  
Tel: +60 126859319  
E-mail: [info.my@prosetechnologies.com](mailto:info.my@prosetechnologies.com)

**Bangkok - Thailand**  
**PROSE Technology (Thailand) Co., Ltd**  
Add.: 349 SJ Infinite I Business Complex, 9 Floor, Room  
905, Vibhavadi Rangsit Road, Chom Phon Sun-district,  
Chatuchak District, Bangkok Province, Thailand  
Tel: +66 80 6606630  
E-mail: [info.th@prosetechnologies.com](mailto:info.th@prosetechnologies.com)

**Singapore**  
**PROSE Technologies (Singapore) Pte.Ltd**  
Add.: 10 Anson Road#13-15 International Plaza  
Singapore 079903  
Tel: +6598366793  
E-mail: [info.sg@prosetechnologies.com](mailto:info.sg@prosetechnologies.com)

**Hanoi - Vietnam**  
**PROSE Technologies (Vietnam) Company Limited**  
Add.: Floor 15, Vinaconex 9 Building, HH-2 Block,  
Pham Hung Street, Me Tri Ward, Nam Tu Liem District,  
Hanoi, Vietnam  
Tel: +84 933086498  
E-mail: [info.vn@prosetechnologies.com](mailto:info.vn@prosetechnologies.com)

**Taguig - Philippines**  
**PROSE Technologies Philippines, Inc.**  
Add.: Unit 17 19th Floor Highstreet South Corporate  
Plaza Tower 1, 26th Street corner 9th Avenue, Bonifacio  
Global City, Taguig City, Philippines  
Tel: +63 27572762  
E-mail: [info.ph@prosetechnologies.com](mailto:info.ph@prosetechnologies.com)

**Jakarta - Indonesia**  
**PT. PROSE Technologies Indonesia**  
Add.: Plaza Sentral 6th Floor, Jalan Jenderal Sudirman  
No. 47, Jakarta 12930, Indonesia  
Tel: +62 21 57901997  
E-mail: [info.id@prosetechnologies.com](mailto:info.id@prosetechnologies.com)

### East Asia

**Suzhou - China**  
**PROSE Technologies (Suzhou) Co.,Ltd**  
Add.: No. 6, Shen'an Road, DianShanHu, Suzhou,  
JiangSu, China  
E-mail: [Info@prosetechnologies.com](mailto:Info@prosetechnologies.com)

**Beijing - China**  
**PROSE Technologies (Beijing) Co.,Ltd**  
E-mail: [Info@prosetechnologies.com](mailto:Info@prosetechnologies.com)

**Shanghai - China**  
**PROSE Technologies (Shanghai) Co.,Ltd**  
E-mail: [Info@prosetechnologies.com](mailto:Info@prosetechnologies.com)

**Dongguan - China**  
Add.: Room 1506, building 1, No. 1, Yile Road,  
Songshanhu Park, Dongguan City, Guangdong  
Province, China  
E-mail: [Info@prosetechnologies.com](mailto:Info@prosetechnologies.com)

**Hongkong - China**  
**PROSE Technologies Company Limited**  
Add.: Unit B 13/F,Prat Commercial Building, 17-19 Prat  
Avenue, Tsimshatsui, Kowloon, HongKong, China  
Tel:+86 512 86896789 - 2921/2922  
E-mail: [info.hk@prosetechnologies.com](mailto:info.hk@prosetechnologies.com)

**Taiwan**  
Tel: +63 2 7572762  
E-mail: [info.tw@prosetechnologies.com](mailto:info.tw@prosetechnologies.com)

### Oceania

**New South Wales - Australia**  
**PROSE Technologies (Australia) Pty. Ltd**  
Add.: 5/13 Boundary Rd, Northmead, NSW 2152,  
Australia  
Tel: +61 2 78055523  
E-mail: [info.au@prosetechnologies.com](mailto:info.au@prosetechnologies.com)